

**SHEET INDEX**

- TITLE SHEET 1
- GENERAL NOTES 2
- EXISTING CONDITIONS AND DEMOLITION PLAN 3
- SCHEMATIC PLAN 4
- GRADING PLAN 5
- GRADING DETAILS 6

**SITE DATA**

PARCEL ID: 282806A003, 282806A113, 282806A004, 282806A005, 282806A006

PRE DEVELOPED IMPERVIOUS AREA: 0.05 ACRES

POST DEVELOPED IMPERVIOUS AREA: 0.11 ACRES

FEMA FLOODPLAIN: 39025C0240G, ZONE X, EFF. 03/16/2006

SITE CONSTRUCTION DOCUMENTS  
FOR  
**PIERCE TOWNSHIP  
SIDEWALK**  
CLERMONT COUNTY, OHIO

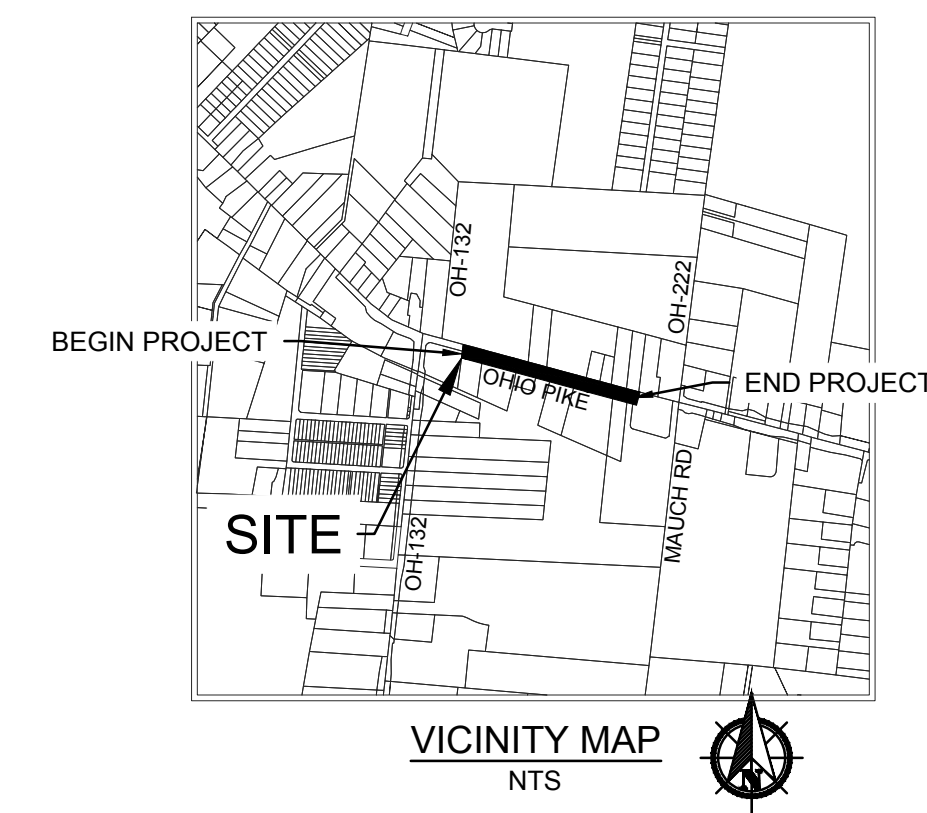

**ENGINEER**  
AMERICAN STRUCTUREPOINT  
2550 CORPORATE EXCHANGE DRIVE, SUITE 300  
COLUMBUS, OHIO 43231  
CONTACT: BENJAMIN D. SCHILLING  
PHONE: 614-901-2235  
EMAIL: BSCHILLING@STRUCTUREPOINT.COM

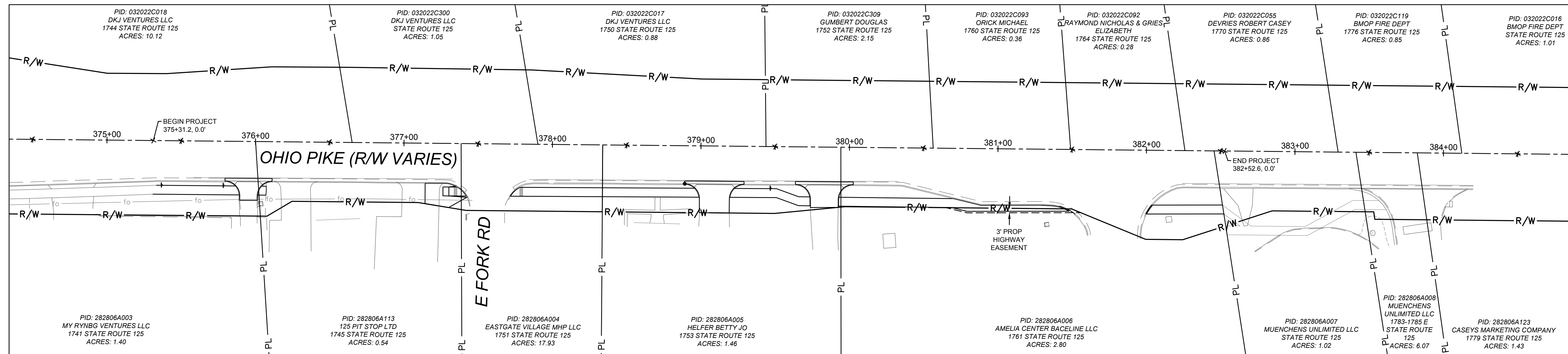

INDEX MAP  
1" = 40'



SITE CONSTRUCTION DOCUMENTS  
FOR  
**PIERCE TOWNSHIP SIDEWALK**  
AMELIA, CLERMONT COUNTY, OHIO  
**TITLE SHEET**

ITEM	DESCRIPTION	UNT	QUANTITY
202	ASPHALT REMOVED, AS PER PLAN	SF	1321
202	CONCRETE REMOVED, AS PER PLAN	SF	14
202	CURB AND GUTTER REMOVED	FT	112
202	REMOVED AS PER PLAN	LS	1
203	EXCAVATION INCLUDING EMBANKMENT CONSTRUCTION, AS PER PLAN	CY	65
204	SUBGRADE COMPACTION	SY	1287
452	NON-REINFORCED CONCRETE PAVEMENT 8" THICK, AS PER PLAN	SF	1233
	SIGN RELOCATED	EACH	3
604	MANHOLE ADJUSTED TO GRADE	EACH	1
608	SIDEWALK	SF	2350
608	CURB RAMP	SF	279
609	ODOT TYPE 2 CURB AND GUTTER, AS PER PLAN	FT	112
614	MAINTAINING TRAFFIC	LS	1
623	CONSTRUCTION LAYOUT STAKES AND SURVEYING	LS	1
659	SEEDING AND MULCHING, CLASS 1, AS PER PLAN	SY	64
832	EROSION CONTROL	EACH	2000

**STANDARD DRAWINGS**

ODOT STANDARD CONSTRUCTION DRAWINGS  
THE STANDARD CONSTRUCTION DRAWINGS LISTED ON THESE PLANS SHALL BE CONSIDERED A PART THEREOF.

BP-4.1  
BP-5.1  
BP-7.1  
MT-095.31

**MUNICIPALITY**

SIGNATURES ON THIS PLAN SIGNIFY ONLY CONCURRENCE WITH THE PURPOSE AND GENERAL LOCATION OF THE PROJECT. ALL TECHNICAL DETAILS REMAIN THE RESPONSIBILITY OF THE ENGINEER PREPARING THE PLANS.

TITLE MUNICIPALITY	DATE
TITLE MUNICIPALITY	DATE
TITLE MUNICIPALITY	DATE
TITLE MUNICIPALITY	DATE
TITLE MUNICIPALITY	DATE
TITLE MUNICIPALITY	DATE

REGISTERED ENGINEER  
BENJAMIN D. SCHILLING, E-86196, P.E. DATE

REVISIONS	DATE	SHEET NO.	DESCRIPTION

**APPROVAL PENDING NOT FOR CONSTRUCTION**  
IN SUBMITTING BIDS IN RELIANCE ON THESE PLANS THE CONTRACTOR ASSUMES ALL RISKS OF ADDITIONAL COSTS OF REVISIONS DUE TO REQUIREMENTS OF THE OWNER OR GOVERNMENTAL AUTHORITIES AND MATERIAL REVISIONS IN THE COURSE OF COMPLETING THE FINAL DESIGN.

DATE: 05/20/2024  
DRAWN BY: LG  
CHECKED BY: BDS  
JOB NUMBER: 2023.02558



PLOT SCALE: 1" = 40' DATE: 5/20/24 11:28 AM EDITED BY: MILLIE DRAWING FILE: O:\2023\02558\C. DESIGN\01\SITE CONSTRUCTION\2023.02558.TS.DWG



PLOT SCALE: 1" = 20' DATE: 5/20/24 - 11:15 AM EDITED BY: MILLIE DRAWING FILE: O:\2023\02558\CONSTRUCTION\2023.02558.DWG

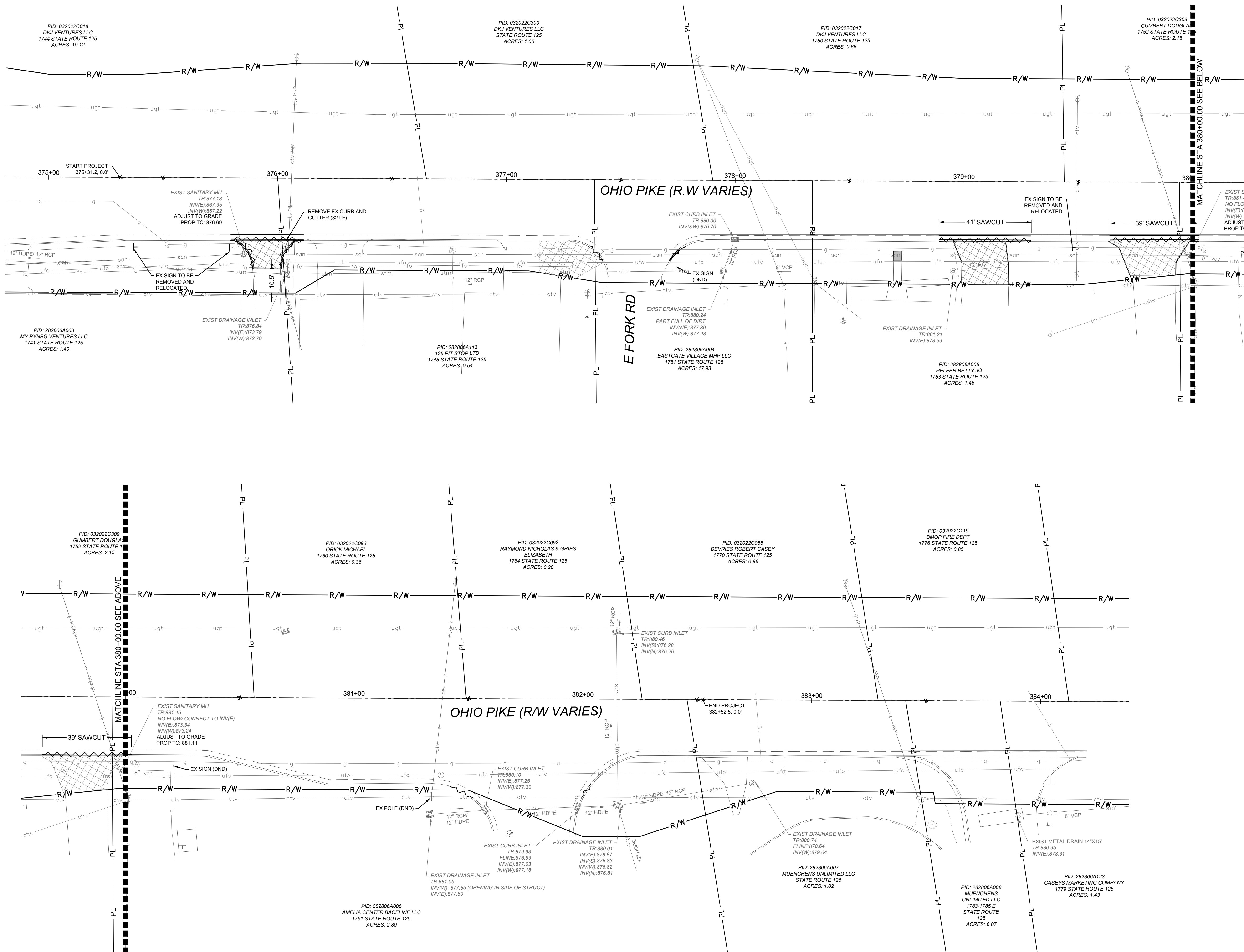

- EXISTING LEGEND**
- PL — PROPERTY LINE
  - R/W — RIGHT-OF-WAY
  - PAVEMENT/ SIDEWALK
  - PAVEMENT STRIPING
  - CURB
  - - - ROAD CENTERLINE
  - stm — STORM SEWER
  - san — SANITARY SEWER
  - w — WATER LINE
  - g — GAS LINE
  - fo — FIBER OPTIC LINE
  - e — ELECTRIC
  - ohe — OVERHEAD ELECTRIC
  - t — TELECOMMUNICATION
  - ctv — CABLE TELEVISION

- DEMOLITION LEGEND**
- TBR TO BE REMOVED
  - DND DO NOT DISTURB
  - ASPHALT TO BE REMOVED
  - CONCRETE TO BE REMOVED
  - CURB REMOVAL



SITE CONSTRUCTION DOCUMENTS  
FOR  
**PIERCE TOWNSHIP SIDEWALK**  
AMELIA, CLERMONT COUNTY, OHIO  
**EXISTING CONDITIONS  
AND DEMOLITION PLAN**

REVISIONS	DATE	SHEET NO.	DESCRIPTION

**APPROVAL PENDING NOT FOR CONSTRUCTION**  
IN SUBMITTING BIDS IN RELIANCE ON THESE PLANS THE CONTRACTOR ASSUMES ALL RISKS OF ADDITIONAL COSTS OF REVISIONS DUE TO REQUIREMENTS OF THE OWNER OR GOVERNMENTAL AUTHORITIES AND MATERIAL REVISIONS IN THE COURSE OF COMPLETING THE FINAL DESIGN.

DATE: 05/20/2024  
DRAWN BY: LG  
CHECKED BY: BDS  
JOB NUMBER: 2023.02558

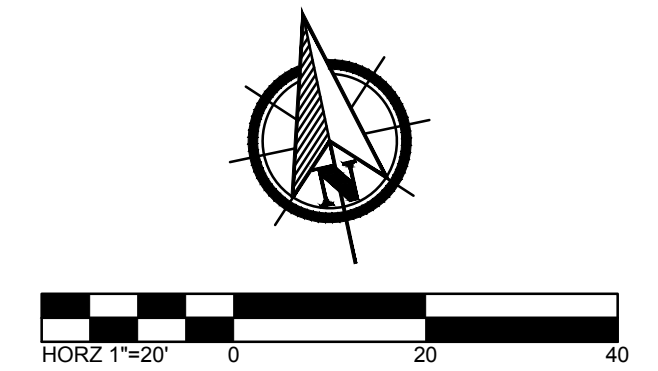

PLOT SCALE: 1" = 20' DATE: 5/20/24 - 11:26 AM EDITED BY: MILLIE DRAWING FILE: O:\2023\02586\C CONSTRUCTION\2023.02586 SCHEM.DWG

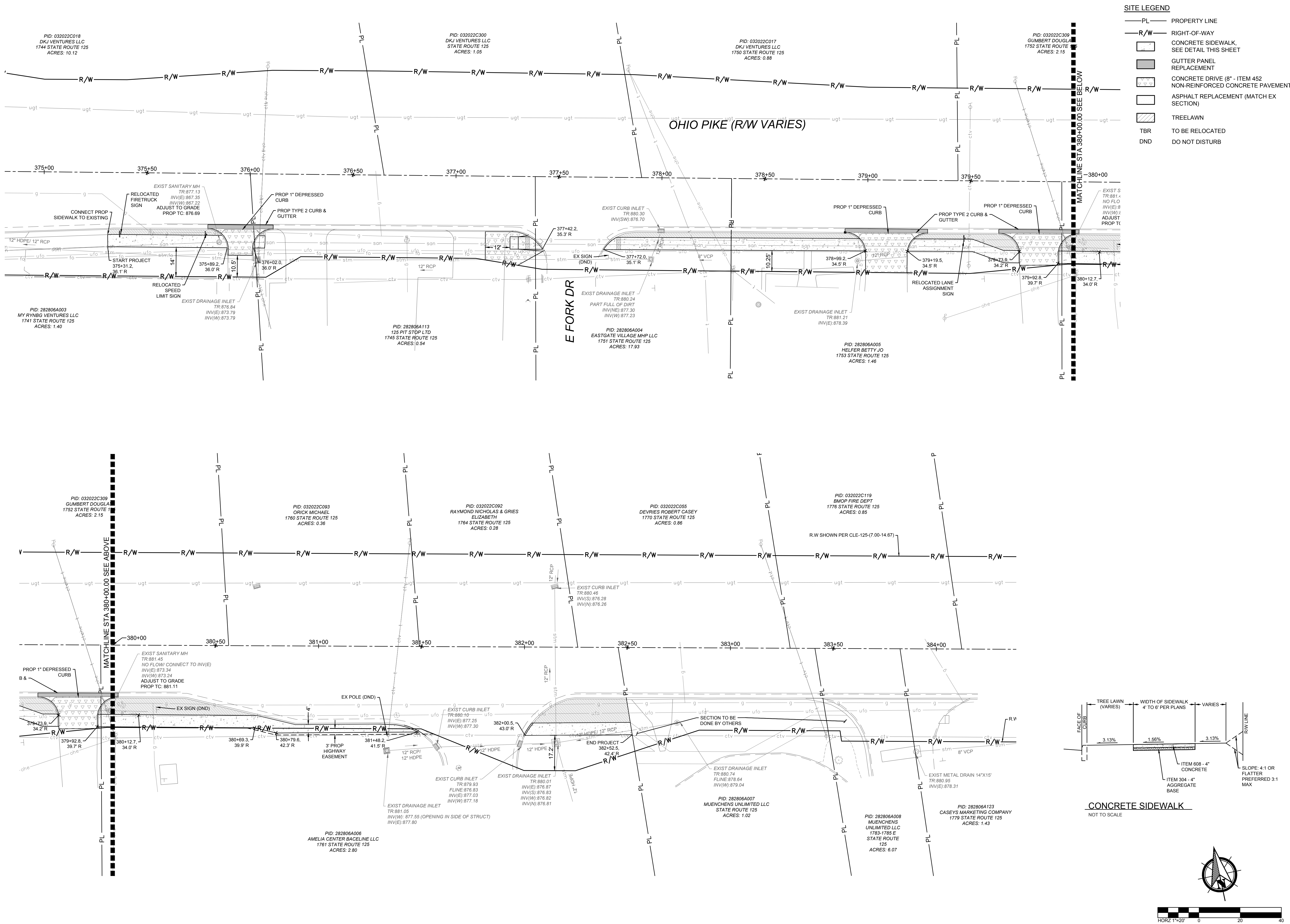

**SITE LEGEND**

- PL — PROPERTY LINE
- R/W — RIGHT-OF-WAY
- ▭ CONCRETE SIDEWALK, SEE DETAIL THIS SHEET
- ▭ GUTTER PANEL REPLACEMENT
- ▭ CONCRETE DRIVE (8" - ITEM 452 NON-REINFORCED CONCRETE PAVEMENT)
- ▭ ASPHALT REPLACEMENT (MATCH EX SECTION)
- ▭ TREELAWN
- TBR TO BE RELOCATED
- DND DO NOT DISTURB

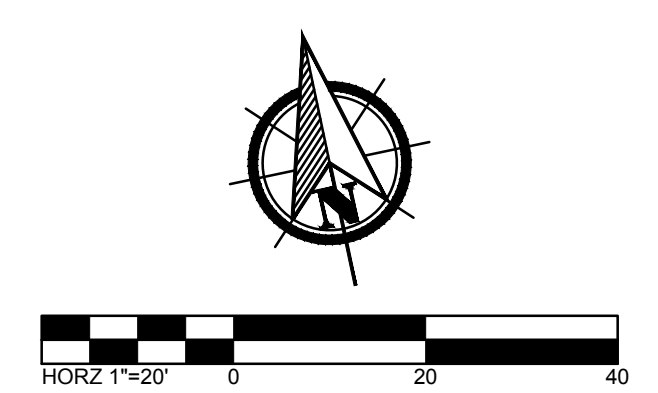
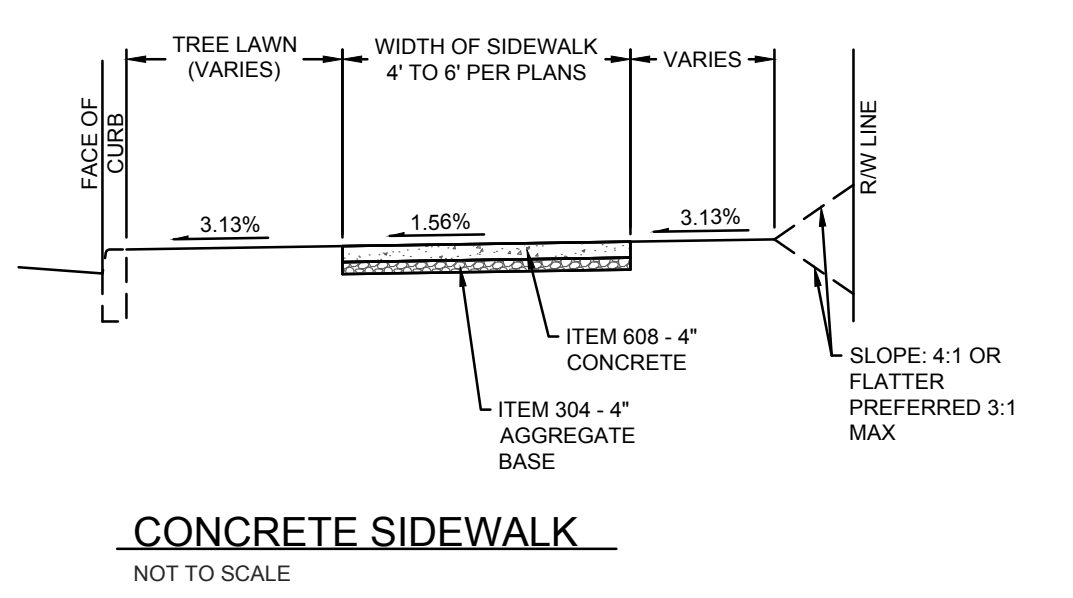

SITE CONSTRUCTION DOCUMENTS  
FOR  
**PIERCE TOWNSHIP SIDEWALK**  
AMELIA, CLERMONT COUNTY, OHIO  
**SCHEMATIC PLAN**

REVISIONS	DATE	DESCRIPTION

**APPROVAL PENDING NOT FOR CONSTRUCTION**  
IN SUBMITTING BIDS IN RELIANCE ON THESE PLANS THE CONTRACTOR ASSUMES ALL RISKS OF ADDITIONAL COSTS OF REVISIONS DUE TO REQUIREMENTS OF THE OWNER OR GOVERNMENTAL AUTHORITIES AND MATERIAL REVISIONS IN THE COURSE OF COMPLETING THE FINAL DESIGN.

DATE: 05/20/2024  
DRAWN BY: LG  
CHECKED BY: BDS  
JOB NUMBER: 2023.02586

PLOT SCALE: 1" = 20' DATE: 5/20/24 11:14 AM EDITED BY: MILLIE DRAWING FILE: O:\2023\0258\0258\CONSTRUCTION\2023.0258.GP DWG

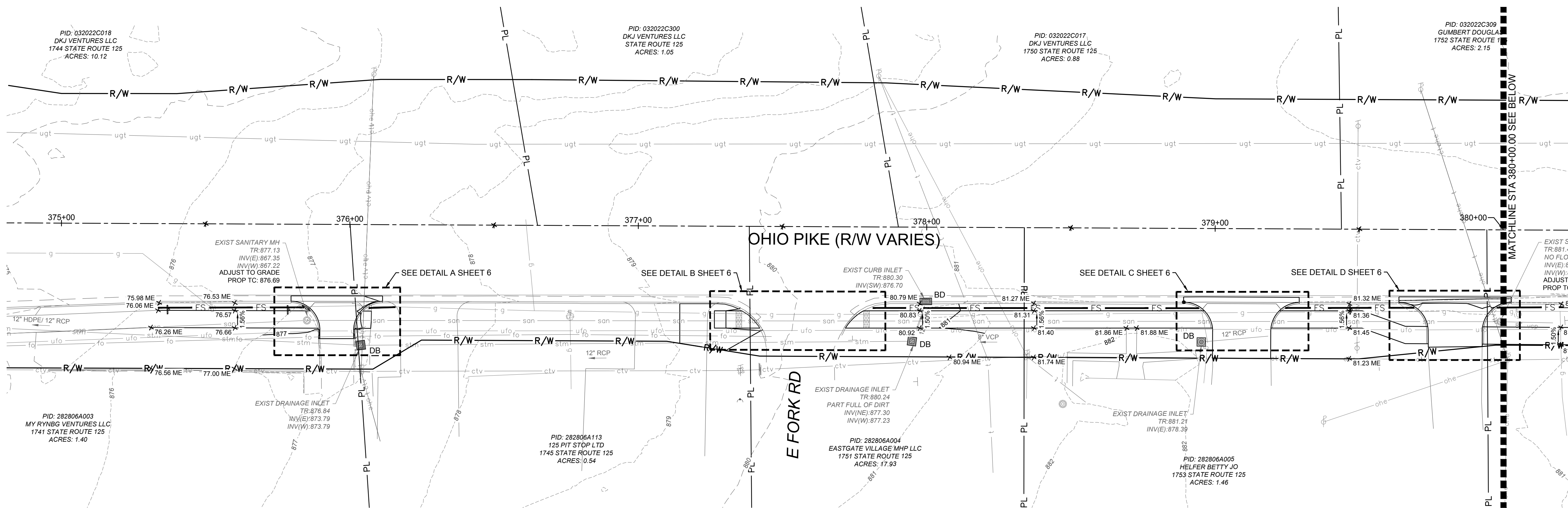

- GRADING LEGEND**
- xxx--- PROPOSED MAJOR CONTOUR
  - xxx--- PROPOSED MINOR CONTOUR
  - - -xxx- - - EXISTING MAJOR CONTOUR
  - - -xxx- - - EXISTING MINOR CONTOUR
  - x10.00 SPOT ELEVATION
  - x10.00 ME MATCH EXISTING ELEVATION
- EROSION CONTROL LEGEND**
- FS FILTER SOCK
  - BD BEAVER DAM INLET PROTECTION
  - SILT FENCE INLET PROTECTION

**GRADING NOTE**

ADD 800.00 TO ALL SPOT ELEVATIONS TO OBTAIN NAVD88 ELEVATIONS.



SITE CONSTRUCTION DOCUMENTS  
FOR  
**PIERCE TOWNSHIP SIDEWALK**  
AMELIA, CLERMONT COUNTY, OHIO  
**GRADING PLAN**

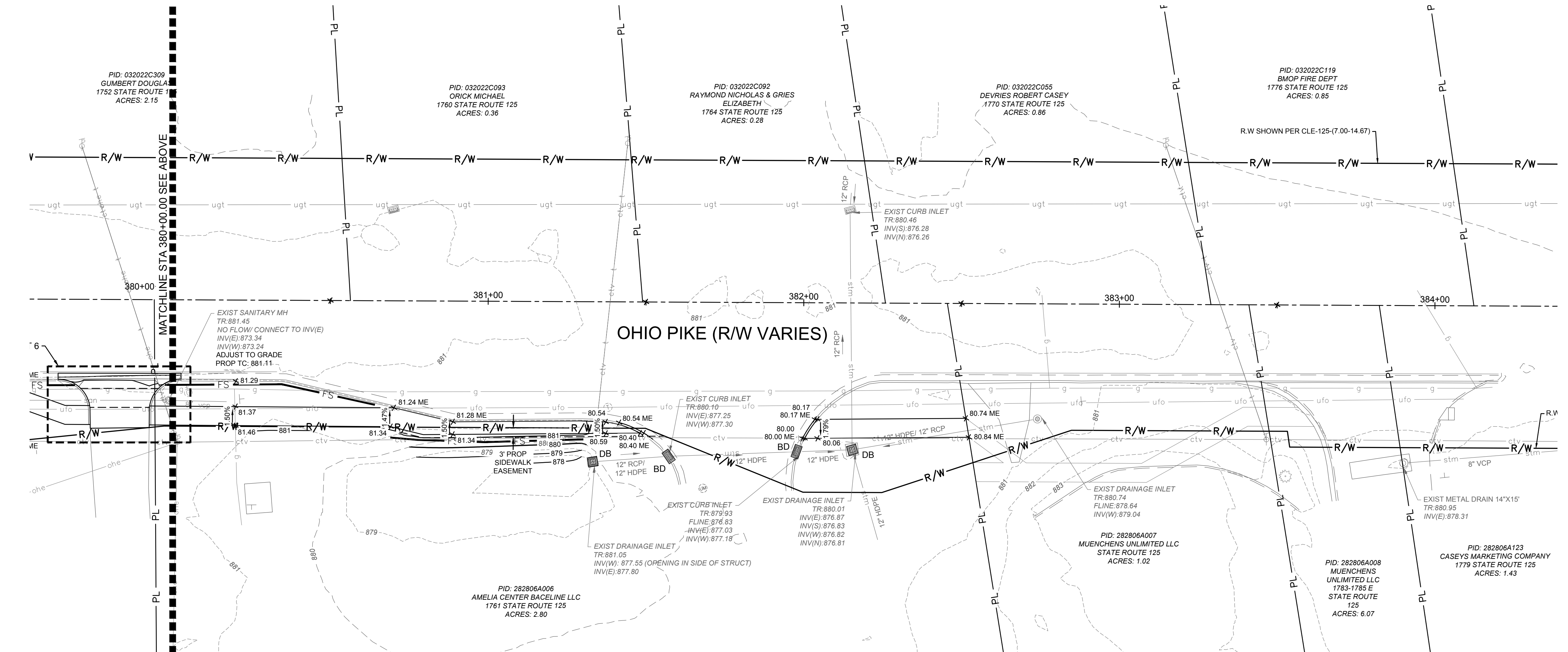

REVISIONS	DATE	SHEET NO.	DESCRIPTION

**APPROVAL PENDING NOT FOR CONSTRUCTION**  
IN SUBMITTING BIDS IN RELIANCE ON THESE PLANS THE CONTRACTOR ASSUMES ALL RISKS OF ADDITIONAL COSTS OF REVISIONS DUE TO REQUIREMENTS OF THE OWNER OR GOVERNMENTAL AUTHORITIES AND MATERIAL REVISIONS IN THE COURSE OF COMPLETING THE FINAL DESIGN.

DATE: 05/20/2024  
DRAWN BY: LG  
CHECKED BY: BDS  
JOB NUMBER: 2023.0258

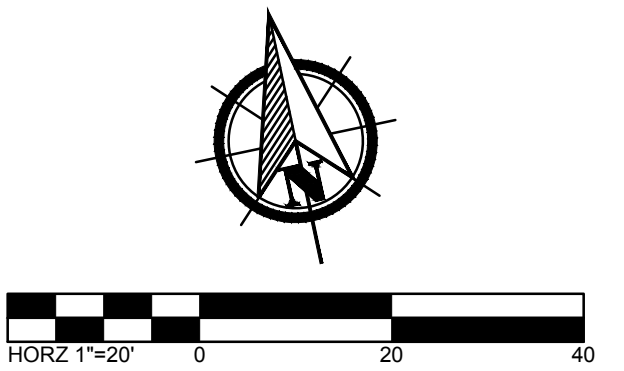

PLOT SCALE: 1" = 5' EDIT DATE: 5/20/24 11:25 AM EDITED BY: MILLIE DRAWING FILE: O:\2023\02558\CONSTRUCTION\2023.02558.GP DET.DWG

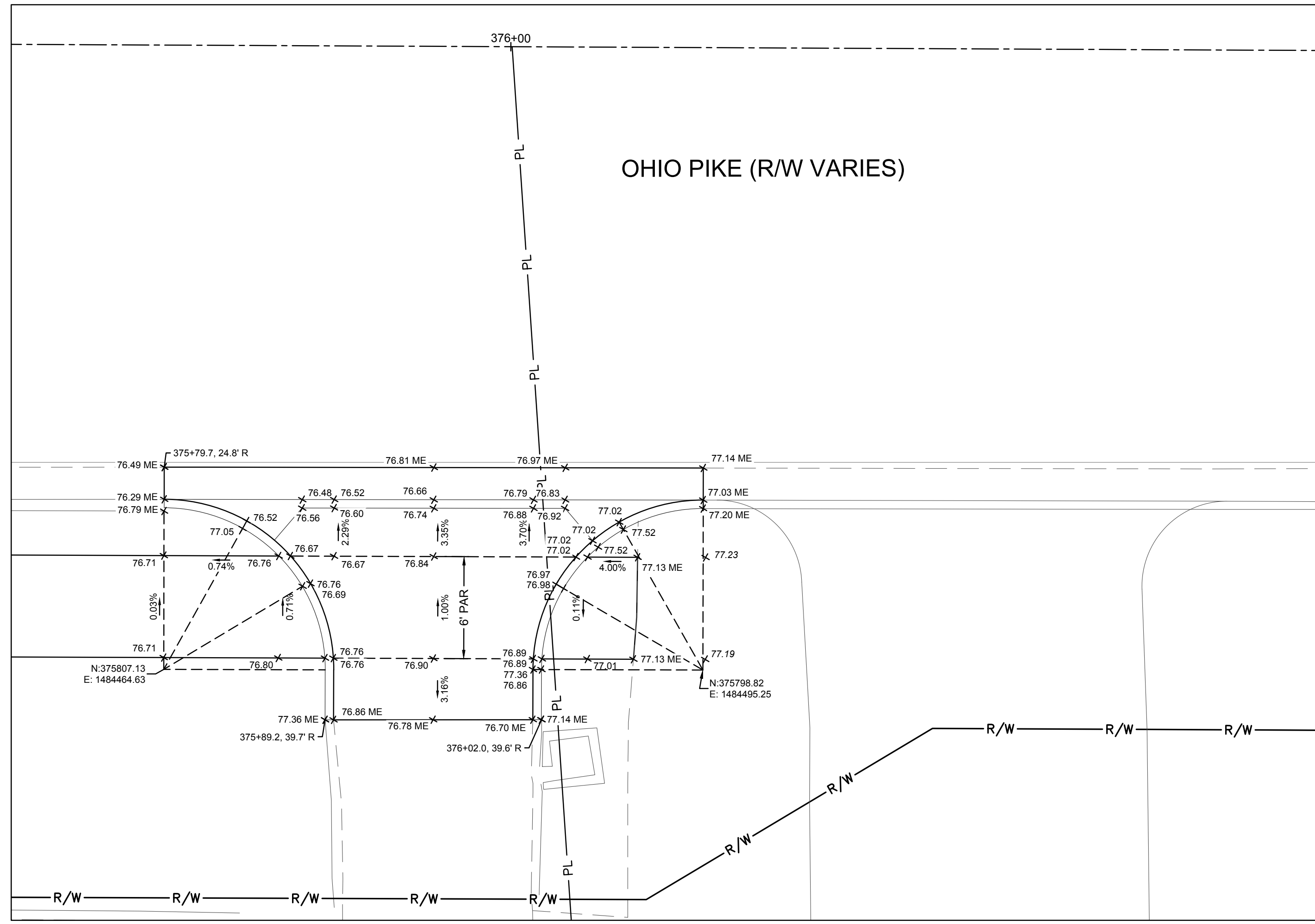

**A** MID AMERICA AUTO GROUP & 125 PIT STOP WEST DRIVE  
HORZ: 1" = 5'

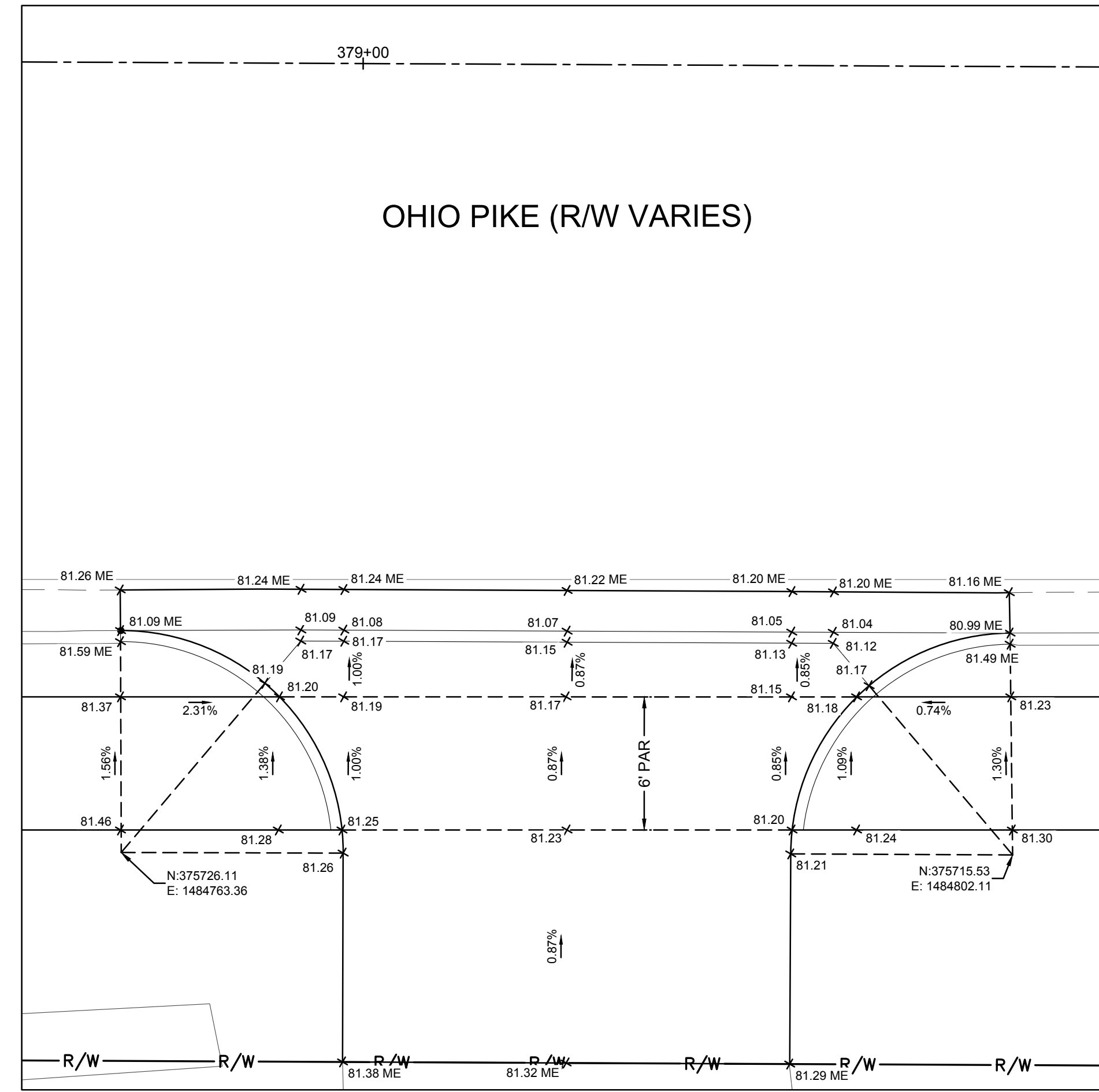

**C** RESIDENTIAL DRIVE  
HORZ: 1" = 5'

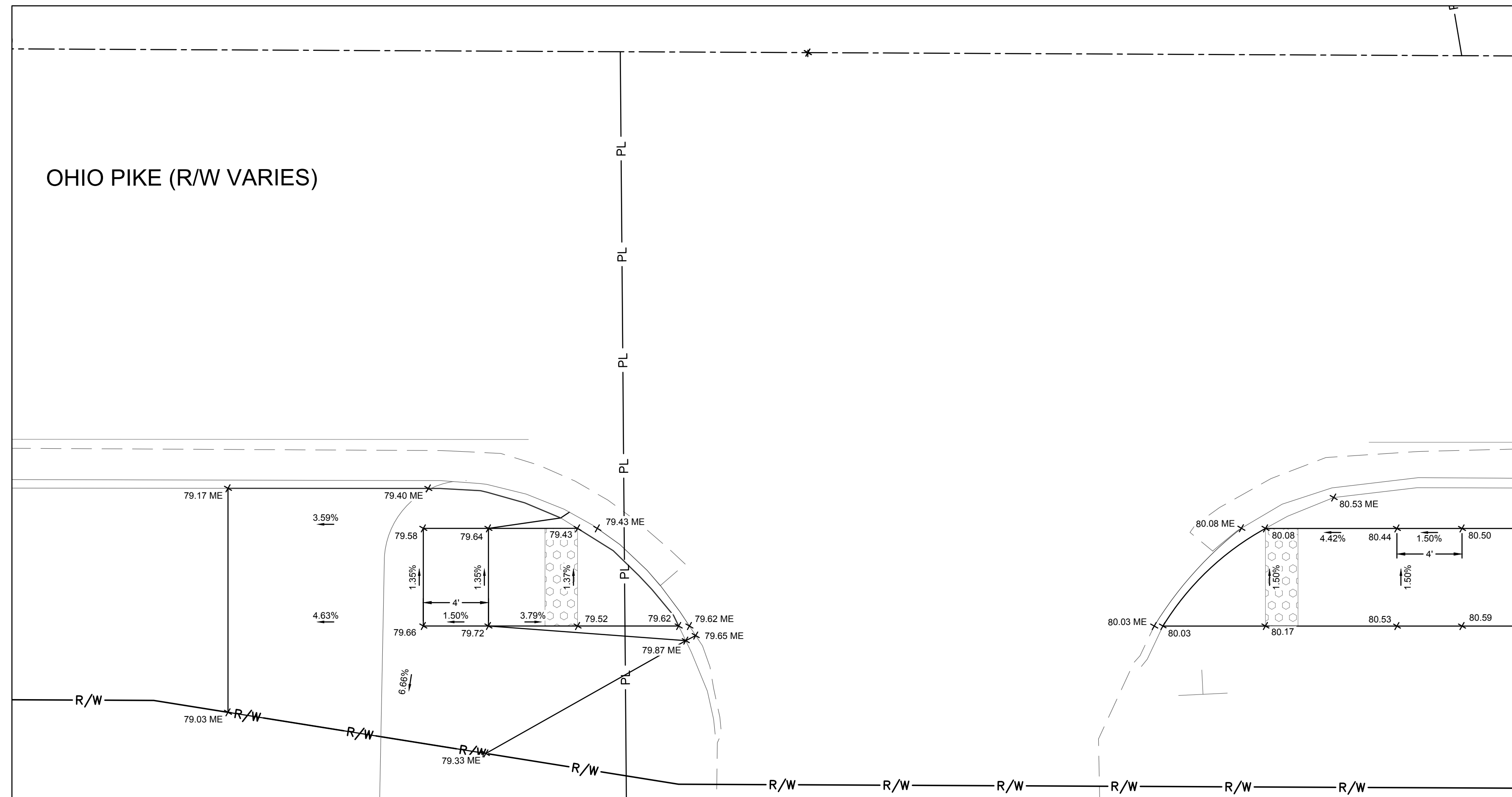

**B** 125 PIT STOP EAST DRIVE  
HORZ: 1" = 5'

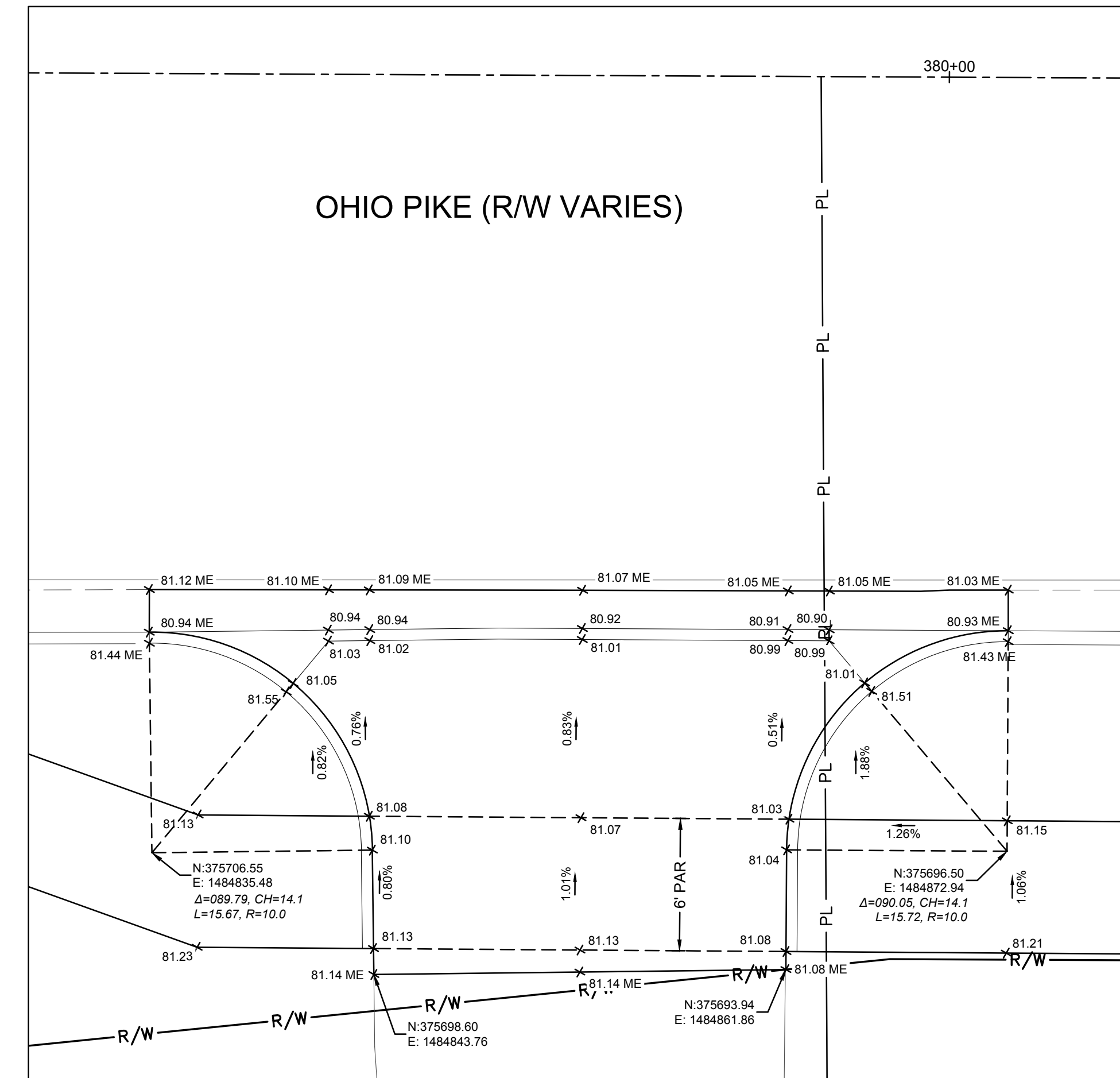

**D** APARTMENT DRIVE  
HORZ: 1" = 5'

- GRADING LEGEND**
- xxx--- PROPOSED MAJOR CONTOUR
  - xxx--- PROPOSED MINOR CONTOUR
  - - -xxx- - - EXISTING MAJOR CONTOUR
  - - -xxx- - - EXISTING MINOR CONTOUR
  - x10.00 SPOT ELEVATION
  - x10.00 ME MATCH EXISTING ELEVATION

**GRADING NOTE**  
ADD 800.00 TO ALL SPOT ELEVATIONS TO OBTAIN NAVD88 ELEVATIONS.



SITE CONSTRUCTION DOCUMENTS  
FOR  
**PIERCE TOWNSHIP SIDEWALK**  
AMELIA, CLERMONT COUNTY, OHIO  
**GRADING DETAILS**

REVISIONS	DATE	DESCRIPTION

**APPROVAL PENDING NOT FOR CONSTRUCTION**  
IN SUBMITTING BIDS IN RELIANCE ON THESE PLANS THE CONTRACTOR ASSUMES ALL RISKS OF ADDITIONAL COSTS OF REVISIONS DUE TO REQUIREMENTS OF THE OWNER OR GOVERNMENTAL AUTHORITIES AND MATERIAL REVISIONS IN THE COURSE OF COMPLETING THE FINAL DESIGN.

DATE: 05/20/2024  
DRAWN BY: LG  
CHECKED BY: BDS  
JOB NUMBER: 2023.02558